

SHOWN WITH NAMUR MOUNTING PLATE AND ACCESSORY DRIVE. IDENTICAL MOUNTING PATTERNS AND SHAFT DRIVE EXIST ON BOTH SIDES, NAMUR ACCESSORIES MAY BE MOVED TO OPPOSITE SIDE.

MOUNTING PATTERNS: F05 AND F07

SHAFT: 17MM FEMALE DOUBLE SQUARE, 1.300 INCHES DEEP (MEASURED FROM MOUNTING SURFACE)

PORT SIZES AS ORDERED, 1/4 NPT STANDARD

CoG MEASUREMENTS SHOWN WITH 8-INCH HANDWHEEL IN EXTENDED POSITION

SHOWN WITH 8-INCH DIAMETER ELEVATED HANDWHEEL. ACTUAL SIZE MAY VARY AS ORDERED.

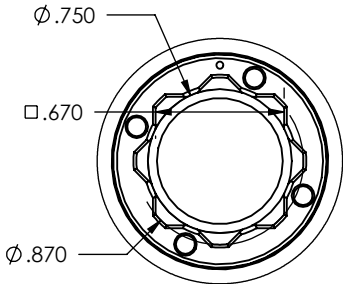

DETAIL A
SCALE 1 : 1



REV.	DESCRIPTION	DATE	DRAWNBY
A	INITIAL	19-JAN-2015	JRH

STATUS	APPROVAL
Released	JRH 19 Jan 15

Except as shown, Dimensions are inches and standard Tolerances are:

- Fractional +/- N/A
- Angular +/- N/A
- 1 Decimal +/- N/A
- 2 Decimal +/- N/A
- 3 Decimal +/- N/A

DO NOT SCALE DRAWING
PROPRIETARY AND CONFIDENTIAL
THE INFORMATION CONTAINED IN THIS DRAWING IS THE SOLE PROPERTY OF QTRCO, INC. ANY REPRODUCTION IN PART OR AS A WHOLE WITHOUT THE WRITTEN PERMISSION OF QTRCO, INC. IS PROHIBITED.

MATERIALS AS SPECIFIED BY PRODUCT LINE STANDARDS AND ORDERED OPTIONS. WEIGHT SHOWN WITH HEAVISET MATERIAL OPTIONS.

DESCRIPTION	REVISION
DWG. NO. Qx205SD-JR-DIM-01	A
WEIGHT (Pounds): 32.455	SHEET 1 OF 1 1 of 1 if not shown
	SIZE A